

Throttle Damper DKG



Ferdinand Schad KG
Steigstraße 25-27
D-78600 Kolbingen
Telephone +49 (0) 74 63 - 980 - 0
Fax +49 (0) 74 63 - 980 - 200
info@schako.de
www.schako.de

Throttle Damper DKG

Contents

Description	3
Construction	3
Model	3
Accessories	3
Models and dimensions	4
Dimensions	4
Dimensions of accessories	5
Technical Data	5
Pressure loss and noise level	5
Legend	6
Order details	6
Specification texts	6

Throttle Damper DKG

Description

The **round, manually adjustable throttle damper DKG** is suitable for installation in round **supply air and return air ducts** according to DIN 24145 or 24146. It is used for regulating the volumetric flows in air-conditioning installations.

The hand-adjustable device **with integrated position indicator** allows an exact setting of the damper blade, without tools, between 0° and 90°. The housing is dimensionally stable due to standard double beads.

For use with airtight locking of volumetric flows, the throttle damper DKG-L must be used.

The throttle dampers types DKG and DKG-L can be used at temperatures between 0°C and +50°C .

Maximum duct pressure 500 Pa.

For maintenance, service, retrofitting, etc., inspection openings in sufficient number and size must be provided on-site.

Advantages:

- stable design
- easy to regulate
- assembly-friendly
- fits position-independent

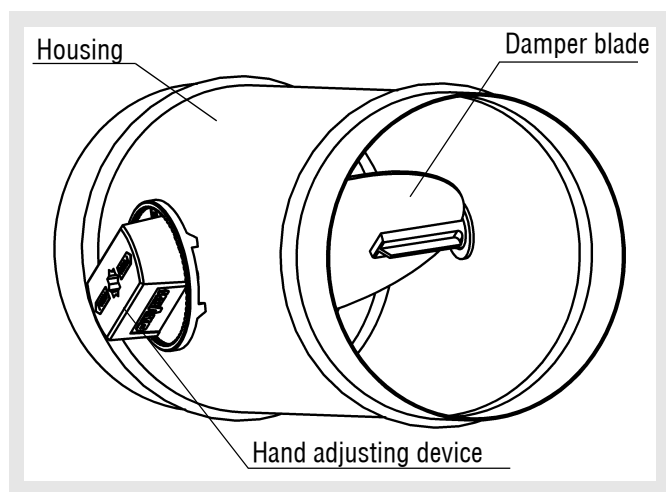

Construction

Housing

- made of galvanised sheet steel
- made of stainless steel 1.4301 (-V2A) or 1.4571 (-V4A)

Control flap

- made of galvanised sheet steel
- made of stainless steel 1.4301 (-V2A) or 1.4571 (-V4A)

Hand adjusting device

- made of plastic

axle bearing

- made of plastic

Model

- | | |
|-------|--|
| DKG | - with sheet steel damper flap |
| DKG-L | - with sheet steel damper leaf and silicone-free damper leaf seal made of PUR (NW 125-400 airtight to DIN 1946 Part 4) |

Accessories

Rubber lip seal (-GD)

- made of special rubber

Electric actuator 3-point (-E)

- 24 V AC/DC, 5 Nm or 10 Nm
- 230 V AC, 5 Nm or 10 Nm

electric actuator 0-10 V (-E)

- 24 V AC/DC, 5 Nm or 10 Nm
- 230 V AC, 5 Nm or 10 Nm

Spring return actuator(-EF)

- 24 V AC/DC, 4 Nm or 15 Nm
- 230 V AC, 4 Nm or 15 Nm

Spring return actuator with integrated limit switch (-EF-IS)

- 24 V AC/DC, 4 Nm or 15 Nm
- 230 V AC, 4 Nm or 15 Nm

Throttle Damper DKG

Models and dimensions

Dimensions

Type DKG / DKG-L

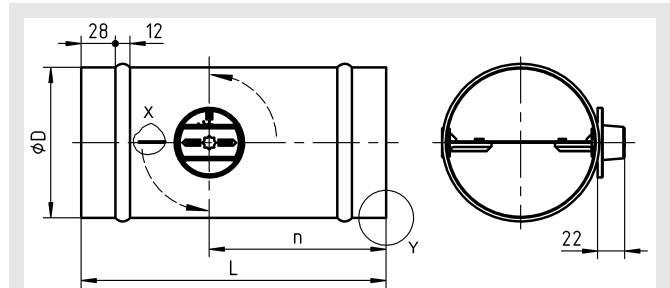

Detail X
DKG

DKG-L
(Sizes 125 - 400 sealing airtight to
DIN 1946/4)

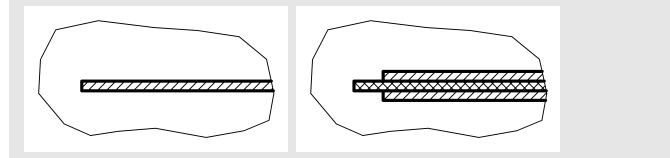

Available sizes

Size	øD	L	n
100	98	250	145
112	110		
125	123		
140	138		
160	158		
180	178		
200	198		
224	222		
250	248	333	185
280	278		
315	313		
355	353		
400	398		

Hand adjusting device 90° Damper blade setting "CLOSED"

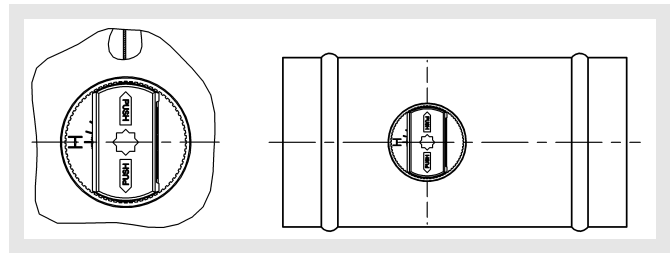

Hand adjusting device 0° Damper blade setting "OPEN"

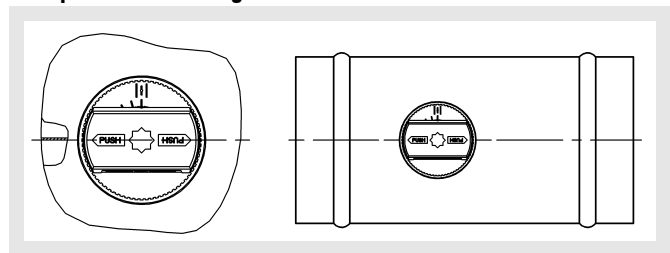

Throttle Damper DKG

Dimensions of accessories

Type DKG-...-E / -EF

(electric actuator / spring return actuator)

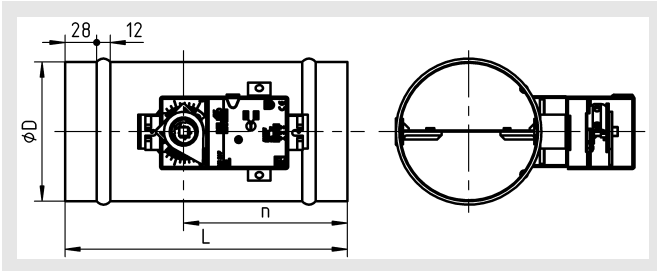

Rubber lip seal (-GD)

Detail Y

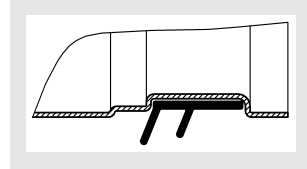

Attention: When motor is fitted on-site, the exact motor type must be specified!

Technical Data

Pressure loss and noise level

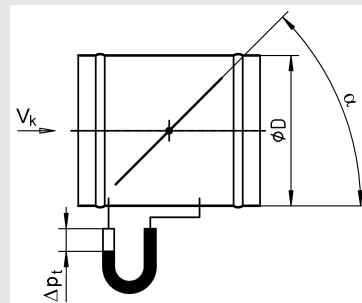
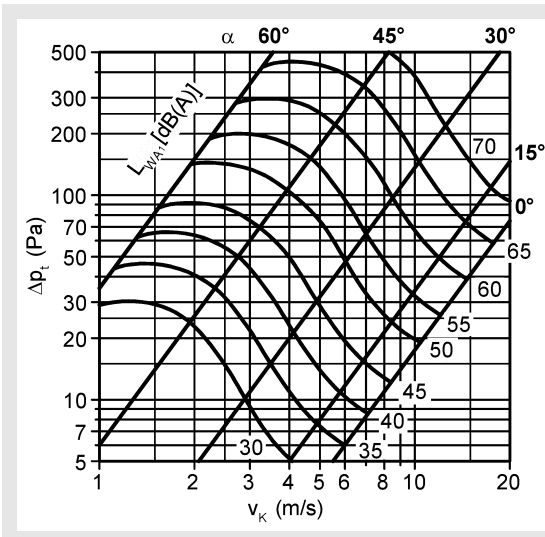

$$L_{WA} = L_{WA1} + KF$$

Correction factor for noise power volume L_{WA1} [dB(A)]

Size	100	112	125	140	160	180	200	224	250	280	315	355	400
KF(-)	-4	-3	-2	-1	0	1	2	3	4	5	6	7	8

The leak volume with closed damper flap is approx. 5%, relative to the volumetric flow with open damper flap and at the same differential pressure.

Duct velocity

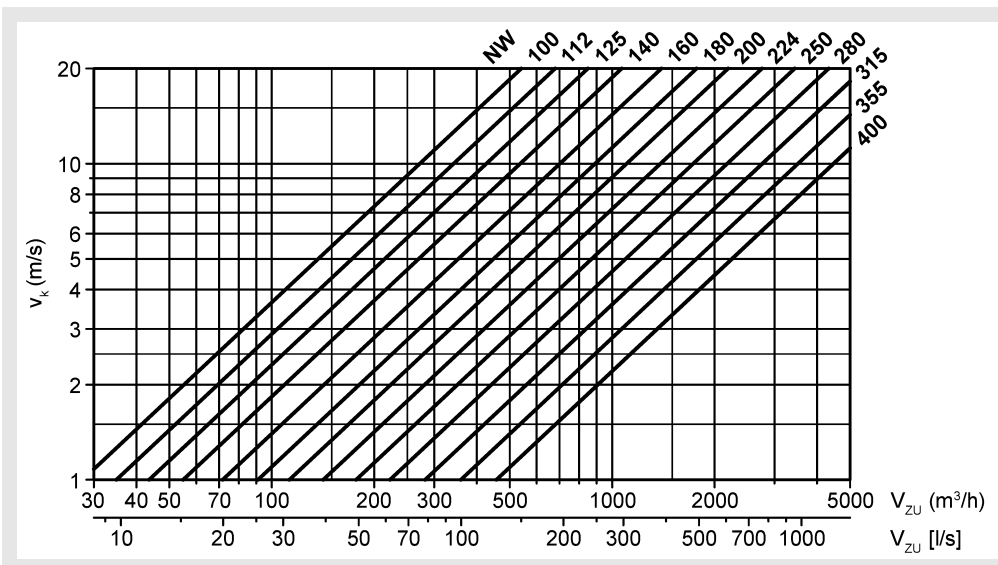

Throttle Damper DKG

Legend

V_{ZU}	(m ³ /h)	= Supply air volume
V_{ZU}	[l/s]	= Supply air volume
v_K	(m/s)	= Duct velocity
Δp_t	(Pa)	= Pressure loss
L_{WA}	[dB(A)]	= A-weighted sound power level ($L_{WA} = L_{WA1} + KF$)
L_{WA1}	[dB(A)]	= A-weighted sound power level, relative to size 160
KF	(-)	= Correction factor
α	(°)	= Damper position
Size	(mm)	= Nominal width

Order details

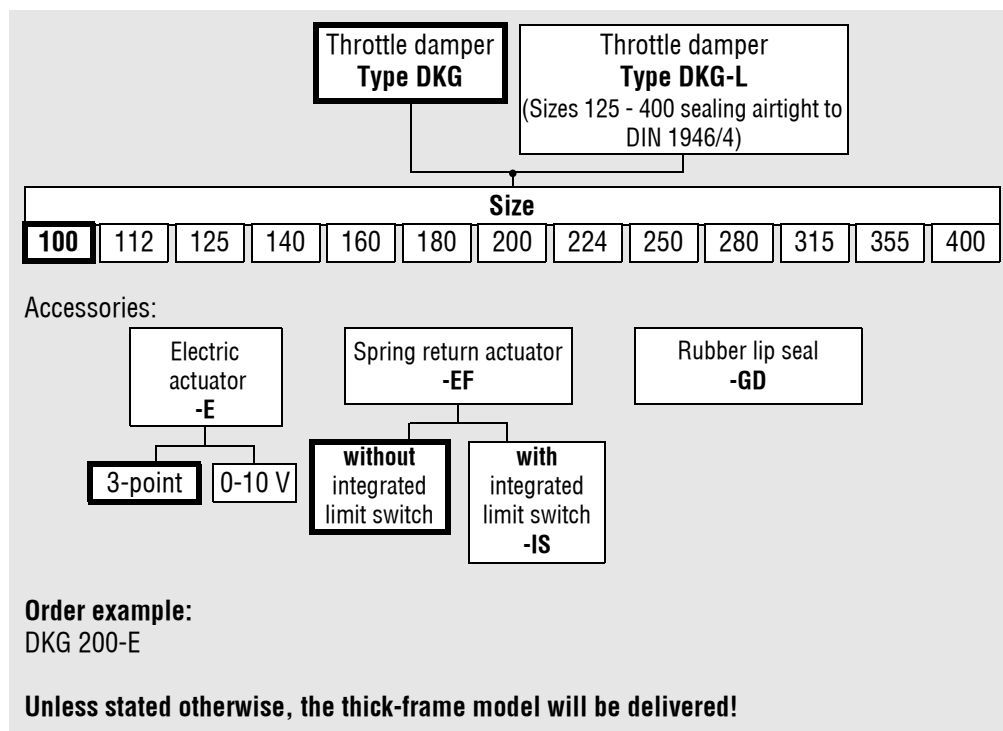

Specification texts

Round, manually adjustable throttle damper **type DKG** is suitable for installation in round supply air and return air ducts according to DIN 24145 or 24146 for regulating the volumetric flows in air-conditioning installations. The housing and adjustable damper blade are made of galvanised sheet steel. The hand adjusting device with position indicator and axle bearing are made of plastic.

Product: SCHAKO **type DKG**

- Damper leaf with silicone-free damper leaf seal made of PUR, NW 125-400 sealing airtight to DIN 1946/4

Product: SCHAKO **type DKG-L**

Accessories (at an extra charge)

- Rubber lip seal (-GD), made of special rubber.
- Electric actuator (-E), 3-point control, 24 V AC / DC or 230 V AC
- Electric actuator (-E), 0-10 V control, 24 V AC / DC or 230 V AC
- Spring return actuator (-EF), 24 V AC / DC or 230 V AC
- Spring return actuator with integrated limit switch (-EF-IS), 24 V AC / DC or 230 V AC