



# Air Diffuser System

## AUDIX<sup>®</sup>-AW

Ferdinand Schad KG  
Steigstraße 25-27  
D-78600 Kolbingen  
Telephone +49 (0) 74 63 - 980 - 0  
Fax +49 (0) 74 63 - 980 - 200  
[info@schako.de](mailto:info@schako.de)  
[www.schako.de](http://www.schako.de)

## Air Diffuser System Model AUDIX®-AW

### Contents

<b>Description</b> .....	<b>3</b>
Construction .....	4
Model .....	5
Accessories .....	5
Fastening .....	5
<b>Models and dimensions</b> .....	<b>6</b>
Dimensions .....	6
Diffuser models .....	7
Dimensions of accessories .....	9
Fastening methods .....	10
Installation .....	10
<b>Technical Data</b> .....	<b>11</b>
Maximum end velocity of jet .....	11
Critical throw .....	14
Temperature and induction ratios .....	16
<b>Legend</b> .....	<b>18</b>
<b>Ordering details</b> .....	<b>19</b>
<b>Specification texts</b> .....	<b>20</b>

## Air Diffuser System Model AUDIX®-AW

### Description

Modern office buildings are often built without suspended ceiling systems. This opens up a saving potential regarding the floor heights. This means that the same building height can accommodate more floors.

The necessity to provide the cheapest possible office space creates conflicts with the demand for comfort. Therefore, in order to reduce the room temperatures, component cooling systems are used in part for the ground load cooling.

According to the thermal insulation regulations, an air-conditioning installation is required for dense facades, to prevent building damage and mould fungus. The necessary supply and return air ducts are preferably installed between the false ceiling in the corridors. In doing so, the main ducts and the connection lines for each room are installed in the smallest possible space. The air diffuser system with integrated cross-talk sound attenuator has been developed for this application. The integrated cross-talk sound attenuator takes over the same function as the cross-talk sound attenuator previously inserted in the ducting system, for which there is seldom sufficient space available. The transmission of cross-talk sound through the network is thus effectively prevented.

The AUDIX®-AW air diffuser system reduces the installation costs, as an additional cross-talk sound attenuator is not required and the integrated cross-talk sound attenuator saves space in the corridor area. The dimensions of the AUDIX®-AW air diffuser system have been adjusted to the requirements in dry building and can be fitted completely in front of lightweight partition walls, thus facilitating the cooperation between the dry builders and the air conditioning installers and saving assembly time. The diffuser can be installed subsequently with a spring connection, so avoiding damage to the diffuser during the construction stage. As an accessory, covers for the opening made of galvanised sheet steel are available, which can be fitted during the building phase to avoid soiling of the box.

The air diffuser system AUDIX®-AW consists of galvanised sheet steel and an inner insulation made of special insulating panels, which are laid out in a reverse labyrinth.

The plenum box can be combined with the slot diffusers from SCHAKO, thus allowing greater design freedom.

The slot diffusers DSC, DSX and DSX-XXL-W allow the ceiling flow to be adjusted and contribute to increasing the efficiency of the convective performance in cooling ceilings with activated concrete ceilings.

The slot diffusers from SCHAKO integrated into the AUDIX®-AW unit achieve a draught-free air pattern with longer throws. The free cross-section remains the same for all adjustable jet directions, as a result of which the pressure loss and the sound volume also stay the same. A subsequent change of the air outlet direction on site is possible at any time, even when the diffuser has already been fitted. The fastening of the slot diffusers is done via springs which allows easy fitting. This also allows easy dismantling, making for easy cleaning of the diffusers.

The AUDIX®-AW units can also be used as combination diffuser for supply and return air as a continuous band with one slot diffuser plenum box each for supply and return air.

A throttle damper with spigot is used to control the air volume and is adjustable from the room side by means of a cord.

### Advantages:

- Prevents air from entering or escaping from the dry wall construction filled with mineral wool, thus creating a hygienically optimum situation.
- The fastening system included in the delivery facilitates mounting, allowing it to be mounted by the RLT or dry builders.
- Excellent sound-absorbing properties
- Acoustic insulating panels of construction material class B1 (standard) or construction material class A2 (non flammable to DIN 4102, at an extra charge)

## Air Diffuser System Model AUDIX®-AW

### Characteristics of each slot diffuser:

#### AUDIX®-AW-...-DSX:

The air outlet direction can be adjusted even when already fitted. In doing so, the free cross-section always remains constant. Likewise, the pressure loss and sound power level do not change. A subsequent adjustment of the air jet pattern to changed room conditions is possible. For adjustment, single blades must be taken out and re-inserted rotated in the required air flow direction. The stable air jet allows the diffuser to be used in VAV systems.

#### AUDIX®-AW-...-DSX-XXL-W:

The air outlet direction has been set in-factory to a horizontal throw, directed slightly upwards. The high induction ensures fast reduction of the air outflow velocity and temperature difference in cooling mode. The stable air jet allows the diffuser to be used in VAV systems.

#### AUDIX®-AW-...-DSC:

The support profile blades produce a stable jet set to a horizontal throw, directed slightly upwards. Due to the central housing of the support profile blades, the free cross-section is always the same. Accordingly, when the blades are adjusted, the pressure loss and sound power level remain constant. An adjustment of the air outflow direction at a later stage is possible at any time, even when the outlet has already been fitted.

#### AUDIX®-AW-...-DSA:

The fixed or adjustable nozzles (-V) produce a stable core jet. The low sound power level allow a high blow velocity with the corresponding throw distances. This ensures that fresh air is circulated through the whole room and not just near the supply air diffuser. The temperature and the velocity are rapidly reduced.

### Construction

#### Plenum box

- Galvanised sheet steel
- with round or rectangular connection pipe

#### Insulation

- Housing inside lined with fibre-free insulating material, formed as reverse labyrinth.
- Acoustic insulating panels of construction material class B1 (standard) or construction material class A2 (non-flammable to DIN 4102)

#### Slot rails

- for the AUDIX®-AW-DSX, AUDIX®-AW-DSX-XXL-W and AUDIX®-AW-DSC models
- Aluminium natural colour anodised E6/EV1
- Aluminium painted to RAL 9010 (white) at an extra charge

#### Faceplate

- for AUDIX®-AW-DSA model
- Sheet steel painted to RAL 9010 (white)

#### Air guide elements

- for the AUDIX®-AW-DSX und AUDIX®-AW-DSX-XXL-W models
- Plastic, RAL colour 9010 (white) or RAL 9005 (black)

#### Blades

- for AUDIX®-AW-DSC model
- Plastic (hard PVC) RAL 9010 (white) or RAL 9005 (black, standard)
- Aluminium painted to the same RAL colour as the frame (at an extra charge). The painted blades cannot be adjusted subsequently

#### Nozzles

- for AUDIX®-AW-DSA model
- Plastic RAL 9010 (white) or RAL 9005 (black)

## Air Diffuser System Model AUDIX®-AW

### Model

AUDIX®-AW-R

- for installation in walls, with round spigot

AUDIX®-AW-RE

- for installation in walls, with rectangular spigot

AUDIX®-AW-...-Z

- only supply air

AUDIX®-AW-...-A

- only return air

AUDIX®-AW-...-Z/A

- for supply and return air

AUDIX®-AW-...-DSX

- with slot diffuser type DSX
  - 1 to 4 slots
  - with narrow frame profile (-P) or wide frame profile (-PB)

AUDIX®-AW-...-DSX-XXL-W

- with slot diffuser type DSX-XXL-W
  - 1 to 2 slots
  - with narrow frame profile (-P) or wide frame profile (-PB)

AUDIX®-AW-...-DSC

- with slot diffuser type DSC
  - 1 to 2 slots
  - with standard frame profile (-) or special frame profile (-P)

AUDIX®-AW-...-DSA

- with nozzle diffuser type DSA
  - 1 row
  - with fixed nozzles (-D) or adjustable nozzles (-VD)

### Accessories

Throttle damper (-DK)

- manually adjustable from corridor
- Throttle damper made of galvanised sheet steel
- Damper fastening made of plastic

Rubber lip seal (-GD)

- Special rubber (AUDIX®-AW-R only)

Cover (-ÖA)

- Galvanised sheet steel

Box neck extension (-KHV)

- for wall thicknesses >100 up to max. 260 mm

### Fastening

Prong fastening (-BK, for AUDIX®-AW...-DSX / -DSX-XXL)

- Concealed fixing via prongs to mount and dismount the diffuser subsequently

Spring mounting (-FM, for AUDIX®-AW...-DSC / -DSA)

- concealed fixing via springs to mount and dismount the diffuser subsequently

# Air Diffuser System Model AUDIX®-AW

## Models and dimensions

### Dimensions

#### AUDIX®-AW-R

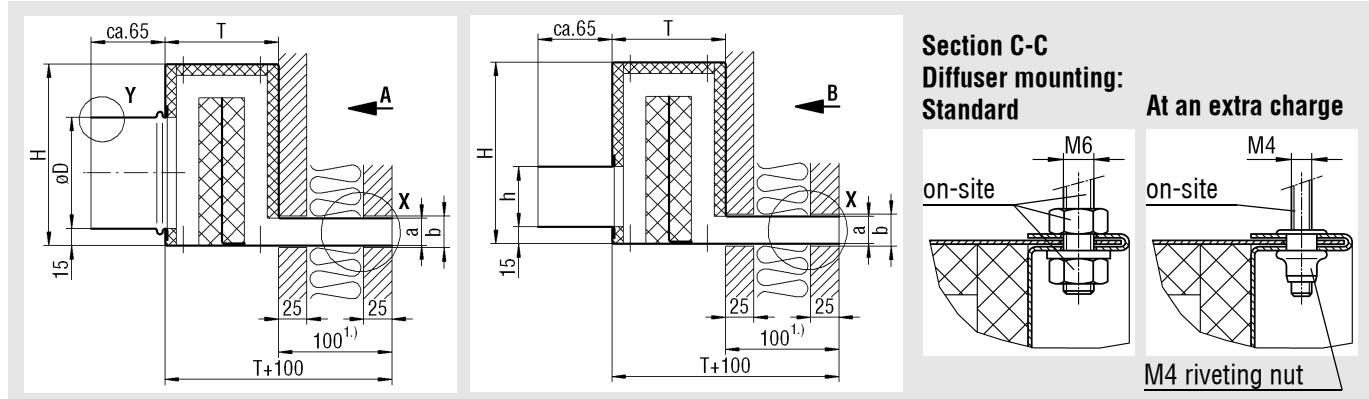

1.) For wall thicknesses >100, a box neck extension (-KHV) up to max. 260 mm is required

### View A

for supply and return air (-Z and -A, respectively)

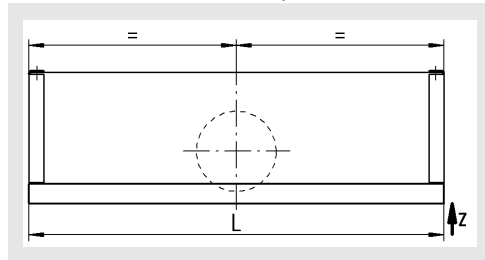

for supply or return air (-Z or -A)

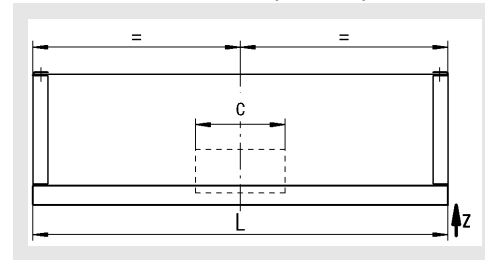

for supply and return air (-Z/A)

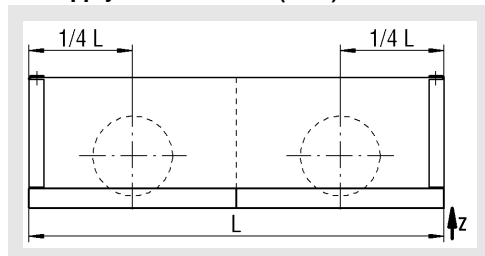

for supply and return air (-Z/A)

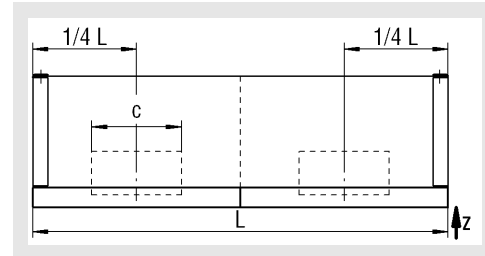

### Available sizes

				AUDIX-AW-R		AUDIX-AW-RE		Number of connection pieces		
		a outside	b (WÖ)	T	øD	H	c	h	H	
<b>DSX</b>	1-slot	26	28	100	98	170	132	55	130	1
	2-slot	40	42	120	123	210	209	55	150	1
	3-slot	54	56	120	123	210	209	55	150	1
	4-slot	68	70	180	123	270	209	55	210	2
<b>DSX-XXL-W</b>	1-slot	44	46	140	138	250	145	100	210	1
	2-slot	76	78	220	138	330	145	100	290	2
<b>DSC</b>	1-slot	53	55	100	98	170	132	55	130	1
	2-slot	92	94	140	138	250	145	100	210	1
<b>DSA-D</b>	1 row of nozzles	68	70	120	123	210	209	55	150	1
<b>DSA-VD</b>	1 row of nozzles	54	56	120	123	210	209	55	150	1

Wall opening in the length: L+5

WÖ = Wall opening

### View Z

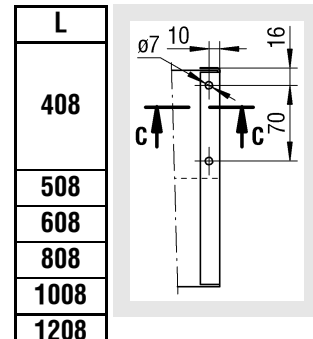

## Air Diffuser System Model AUDIX®-AW

### Diffuser models

#### Detail X

AUDIX®-AW-DSX-P, 1 to 4 slots

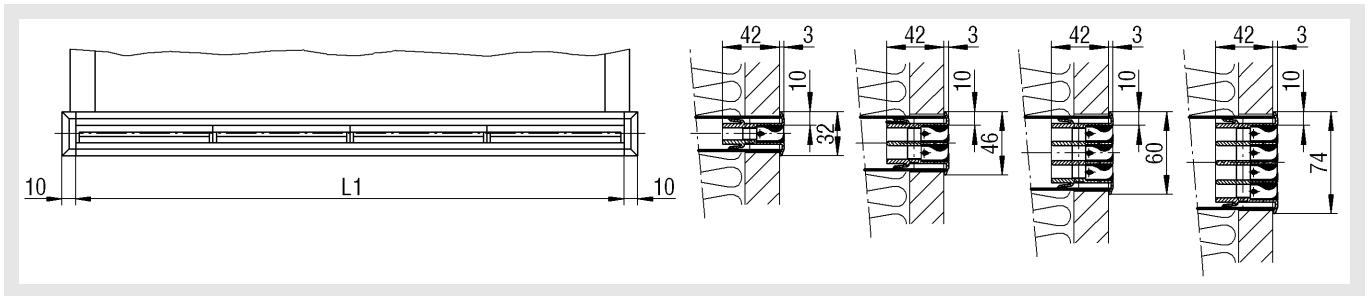

AUDIX®-AW-DSX-PB, 1 to 4 slots

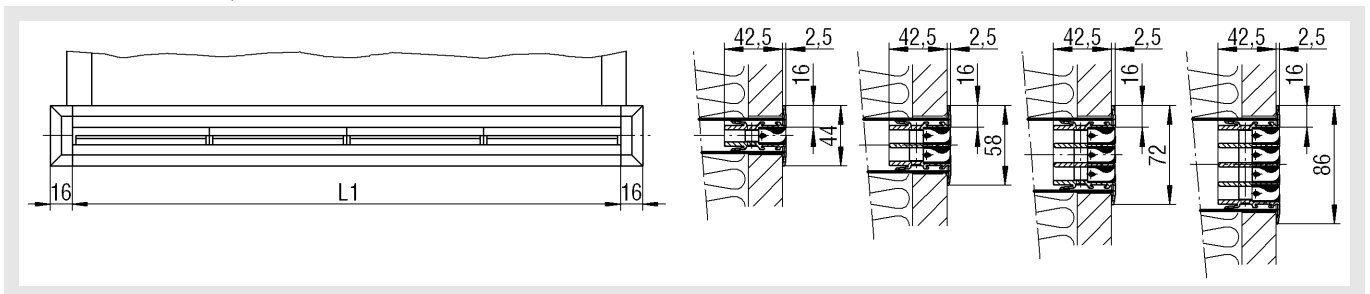

AUDIX®-AW-DSX-XXL-W-P, 1 and 2 slots

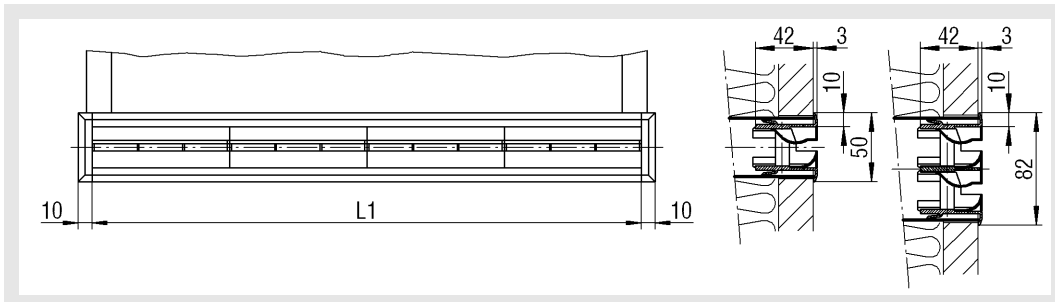

AUDIX®-AW-DSX-XXL-W-PB, 1 and 2 slots

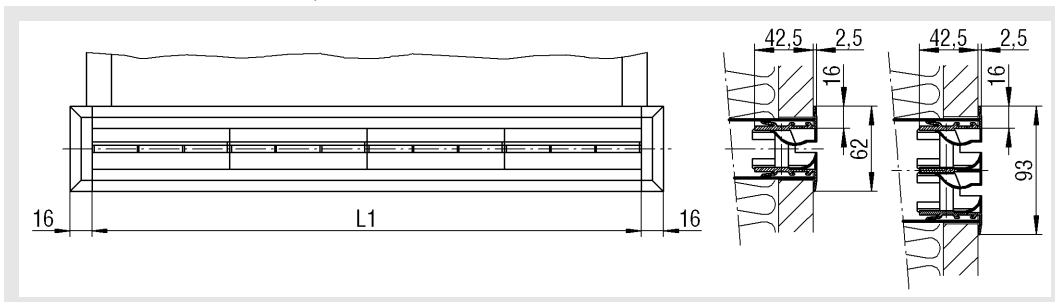

### Available sizes

L	L1
408	400
508	500
608	600
808	800
1008	1000
1208	1200

## Air Diffuser System Model AUDIX®-AW

AUDIX®-AW-DSC, 1 and 2 slots

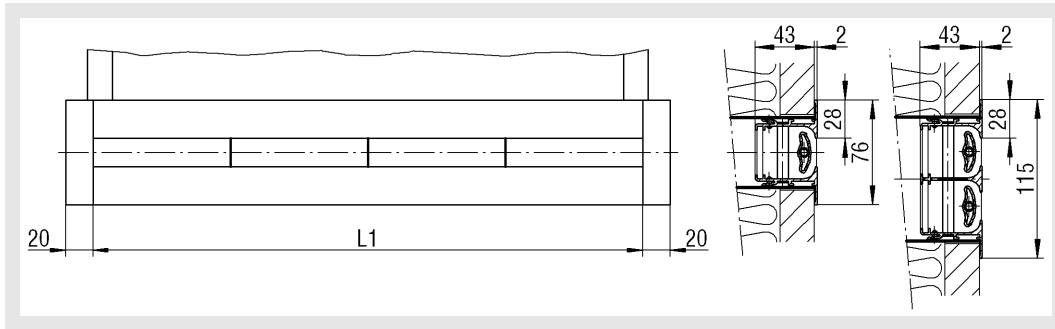

AUDIX®-AW-DSC-P, 1 and 2 slots

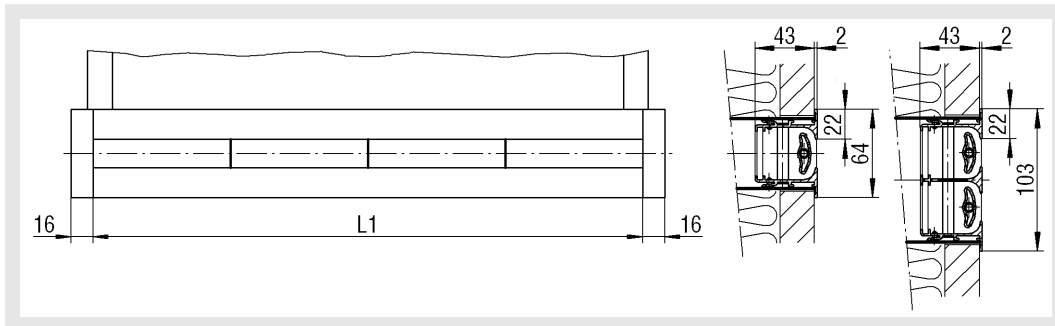

AUDIX®-AW-DSA-D

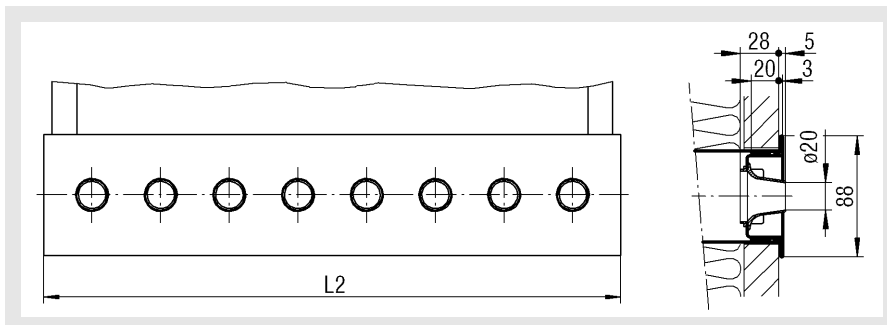

AUDIX®-AW-DSA-VD

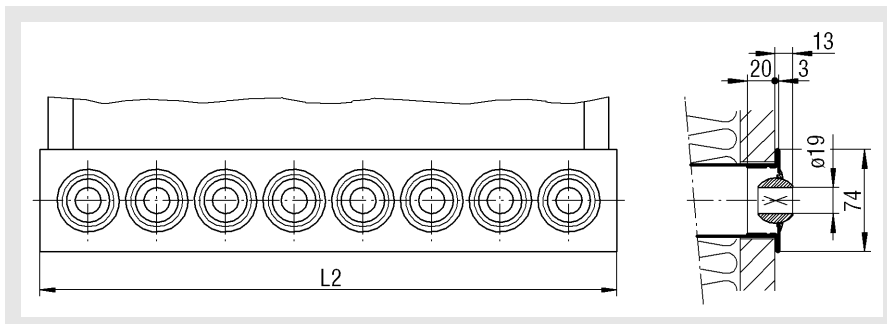

Available sizes

L	L1	L2
408	400	420
508	500	520
608	600	620
808	800	820
1008	1000	1020
1208	1200	1220

## Air Diffuser System Model AUDIX®-AW

### Dimensions of accessories

Throttle damper (-DK), with cord adjustment  
AUDIX®-AW-R                      AUDIX®-AW-RE

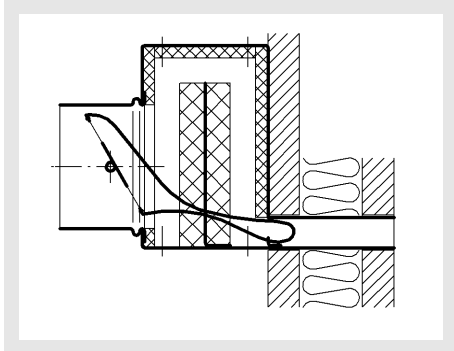

AUDIX®-AW-RE

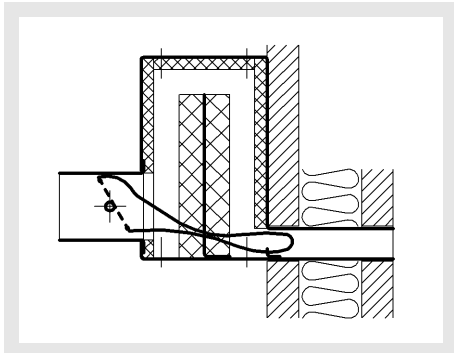

### Cover (-ÖA)

To prevent soiling or damage during assembly.

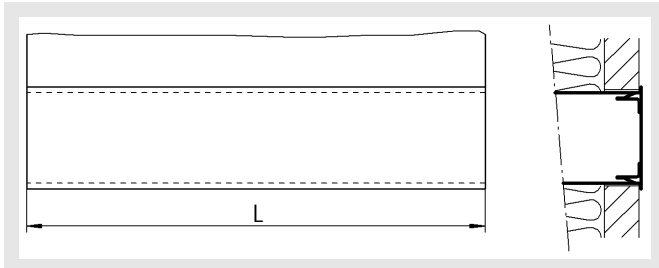

Box neck extension (-KHV)  
AUDIX®-AW-R-KHV

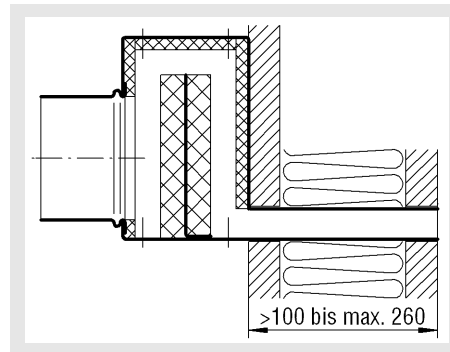

AUDIX®-AW-RE-KHV

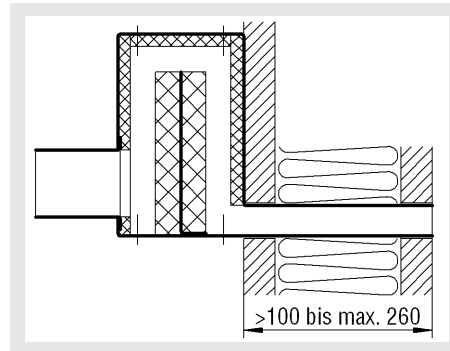

Rubber lip seal (-GD)  
(only AUDIX®-AW-R)  
Detail W

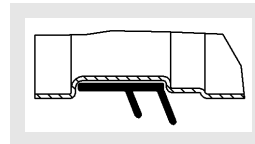

## Air Diffuser System Model AUDIX®-AW

### Fastening methods

Prong fastening (-BK, for AUDIX®-AW...-DSX / -DSX-XXL)

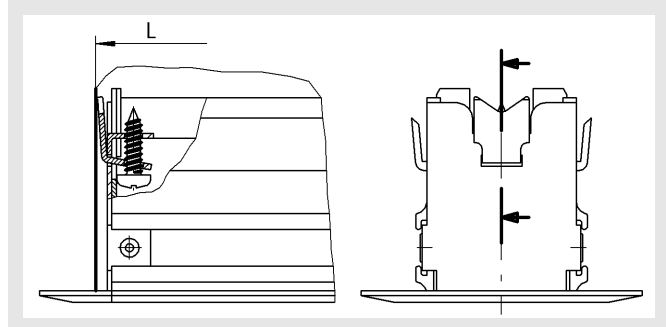

The prong connection (-BK) is always attached to the front (to the end pieces).

Spring mounting (-FM) (for AUDIX®-AW...-DSC / -DSA)

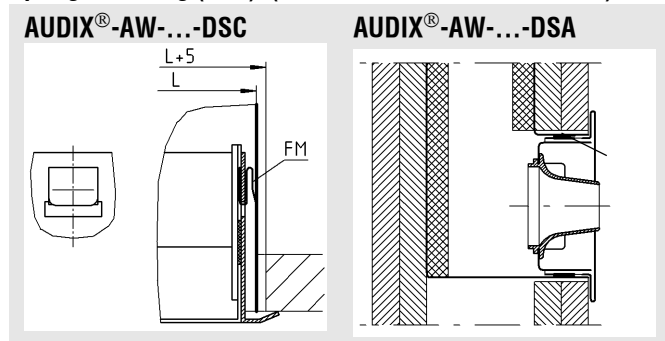

The spring connection (-FM) is always attached to the longitudinal side at the diffuser.

### Installation

Optimum installation

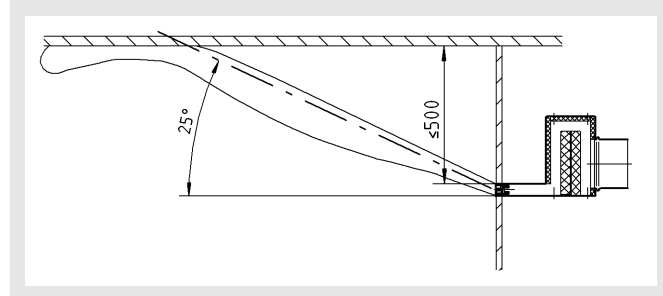

The clearance between ceiling and upper edge of the diffuser must not exceed 0.5 m, otherwise no coanda effect is achieved!

Installation of plenum box rotated

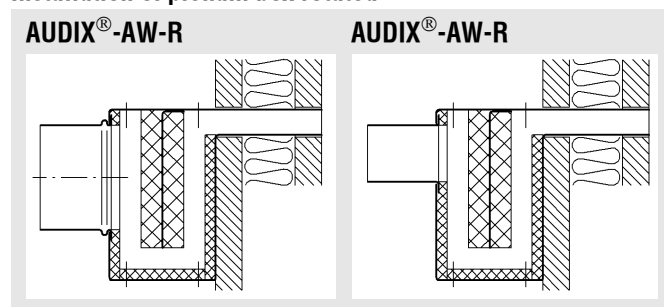

At an extra charge, the plenum box can be mounted rotated.

#### Attention!

If the plenum box is mounted rotated, there is a risk of dirt deposits in the box lower portion.

### Mounting information

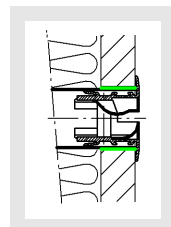
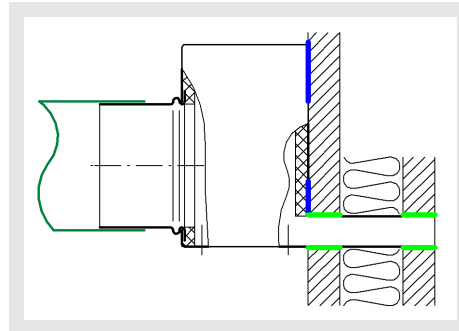

Additional on-site sound-absorbing strips  
Close gap between box neck and wall planking  
with permanently elastic material.

## Air Diffuser System Model AUDIX®-AW

### Technical Data

#### Maximum end velocity of jet

AUDIX®-AW-DSX-...-1/2/3/4

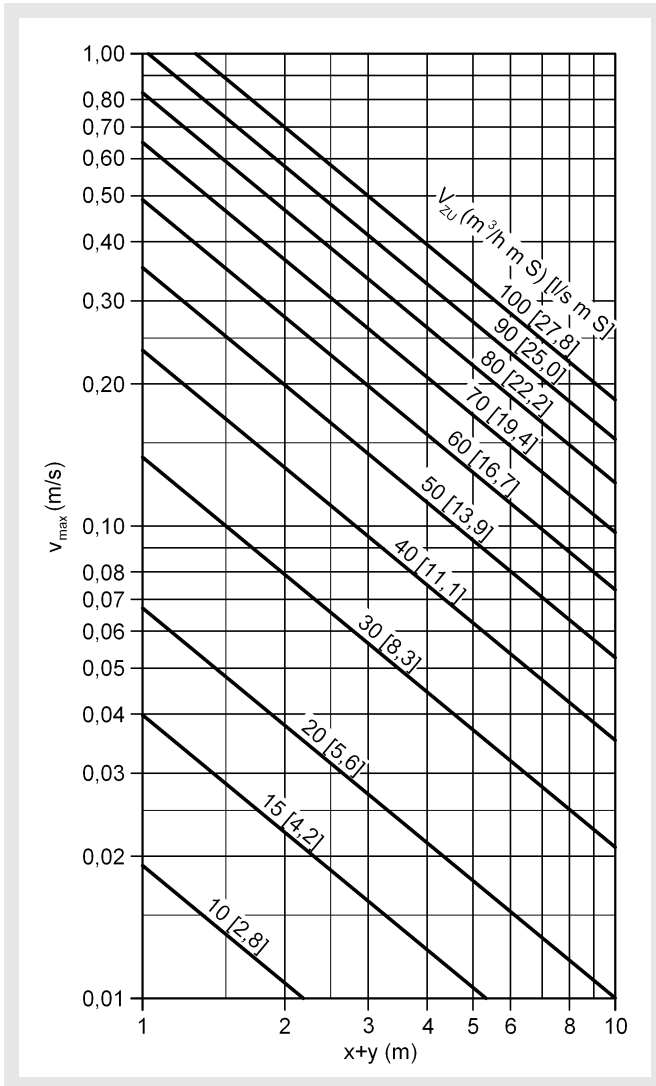

#### Correction factors for maximum end velocity of jet DSX

Slot lengths	c factor			
	DSX-1	DSX-2	DSX-3	DSX-4
1200mm	x0,80	x1,22	x2,02	x2,25
1000mm	x1,00	x1,53	x2,53	x2,81
900mm	x1,11	x1,70	x2,80	x3,11
800mm	x1,25	x1,70	x2,80	x3,51
700mm	x1,42	x2,17	x3,59	x3,99
600mm	x1,66	x2,54	x4,25	x4,66
500mm	x2,00	x3,06	x5,06	x5,62
400mm	x2,50	x3,82	x6,33	x7,02

#### AUDIX®-AW-DSX-XXL-W-...-1/2

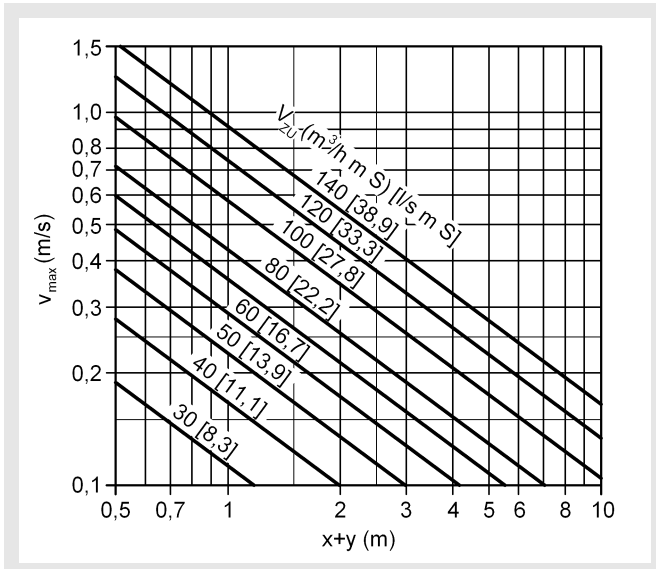

#### Correction factors for maximum end velocity of jet DSX-XXL-W

Slot lengths	c factor	
	DSX-XXL-W-1	DSX-XXL-W-2
1200mm	x0,80	x1,06
1000mm	x1,00	x1,33
900mm	x1,11	x1,48
800mm	x1,25	x1,45
700mm	x1,42	x1,66
600mm	x1,66	x2,21
500mm	x2,00	x2,66
400mm	x2,50	x3,33

# Air Diffuser System Model AUDIX®-AW

## AUDIX®-AW-DSC-401/402

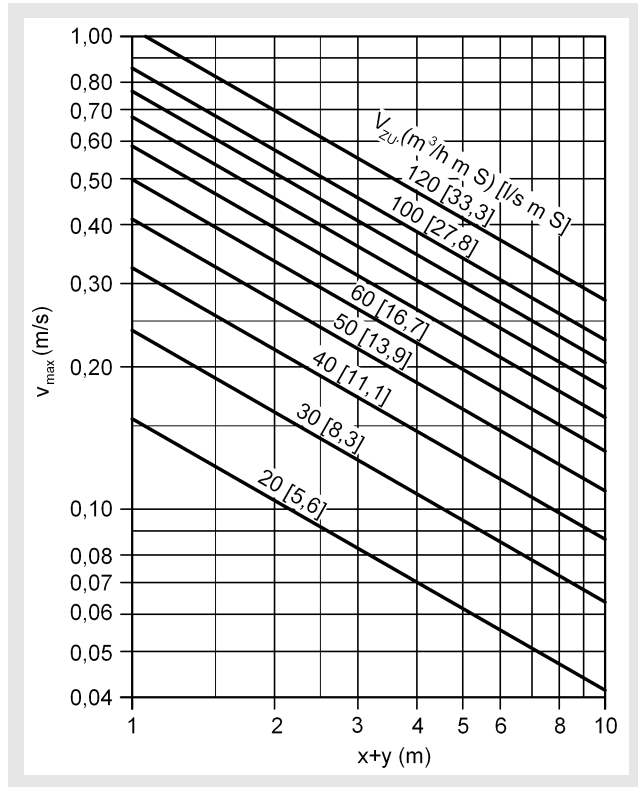

### Correction factors for maximum end velocity of jet DSC

Slot lengths	c factor	
	DSC-401	DSC-402
1200mm	x0,80	x1,26
1000mm	x1,00	x1,58
900mm	x1,11	x1,75
800mm	x1,25	x1,97
700mm	x1,42	x2,25
600mm	x1,66	x2,62
500mm	x2,00	x3,16
400mm	x2,50	3,95

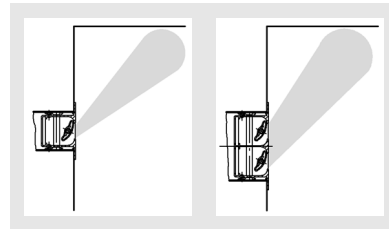

## AUDIX®-AW-DSA-D-1

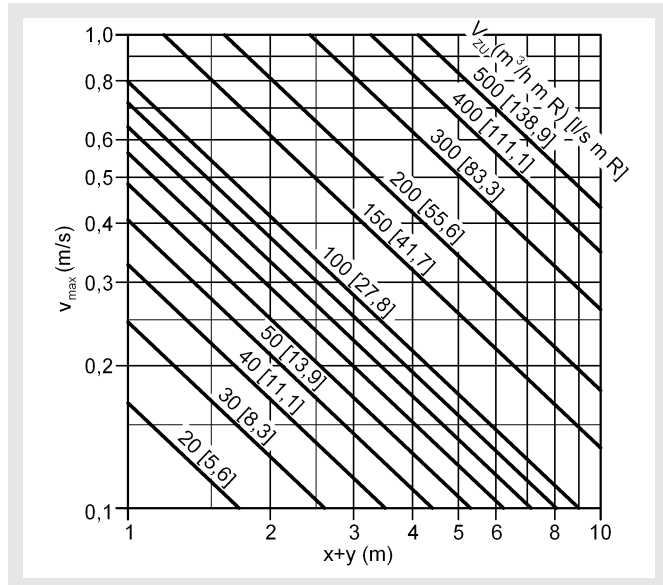

### Correction factors for maximum end velocity of jet DSA-D

Slot lengths	c factor
	DSA-D-1
1200mm	x0,80
1000mm	x1,00
900mm	x1,11
800mm	x1,25
700mm	x1,42
600mm	x1,66
500mm	x2,00
400mm	x2,50

# Air Diffuser System Model AUDIX®-AW

## AUDIX®-AW-DSA-VD-1

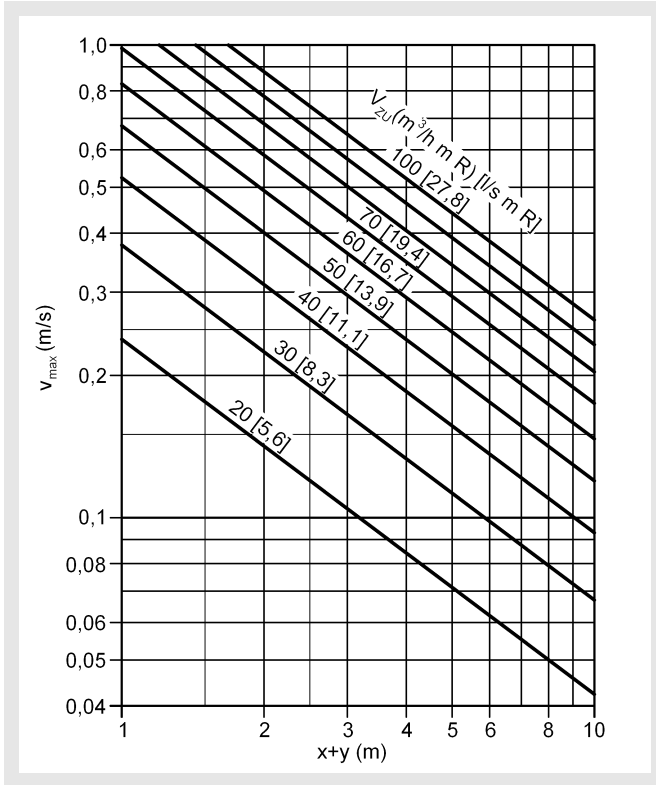

## Correction factors for maximum end velocity of jet DSA-VD

Slot lengths	c factor	
	DSA-VD positioned upwards	DSA-VD positioned straight
1200mm	x0,87	x0,94
1000mm	x1,00	x1,09
900mm	x1,07	x1,22
800mm	x1,14	x1,34
700mm	x1,28	x1,45
600mm	x1,42	x1,56
500mm	x1,55	x1,74
400mm	x1,66	x1,88

Maximum assembly dimension to achieve a coanda effect  
 Nozzles positioned upwards      Nozzles positioned straight

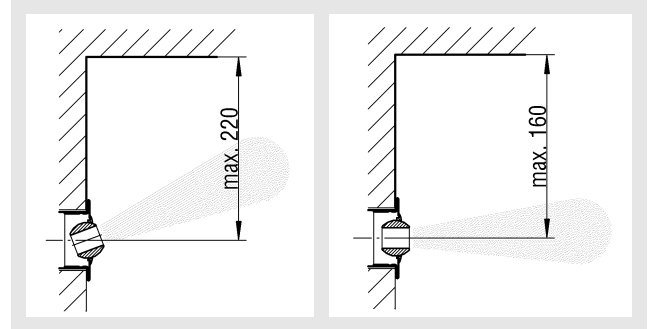

## Air Diffuser System Model AUDIX®-AW

### Critical throw

#### AUDIX®-AW-DSX-1/2/3/4

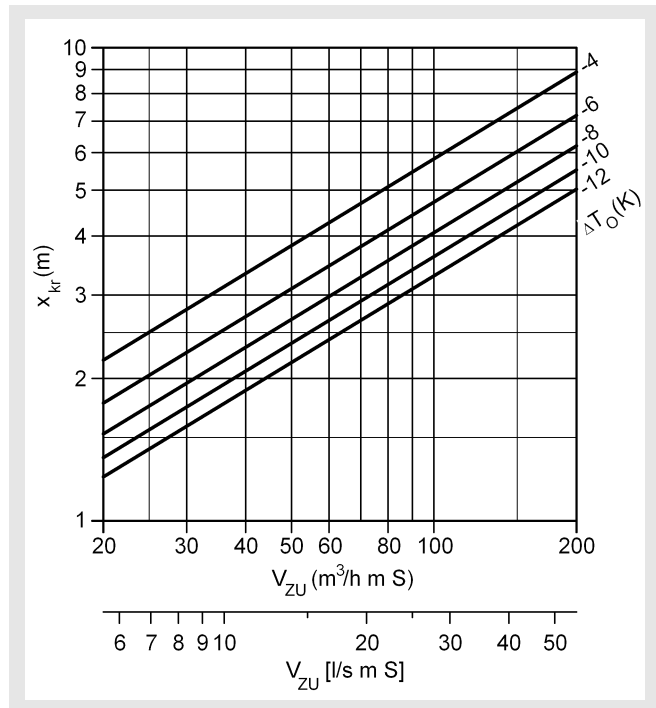

#### Correction factors for x-critical DSX

Slot lengths	c factor			
	DSX-1	DSX-2	DSX-3	DSX-4
1200mm	x0,80	x0,82	x1,06	x1,22
1000mm	x1,00	1,03	x1,33	x1,52
900mm	x1,11	x1,14	x1,47	x1,68
800mm	x1,25	x1,28	x1,66	x1,90
700mm	x1,42	x1,46	x1,88	x2,15
600mm	x1,66	x1,70	x2,20	x2,52
500mm	x2,00	x2,06	x2,66	x3,04
400mm	x2,50	x2,57	x3,32	x3,80

#### AUDIX®-AW-DSX-XXL-W-1/2

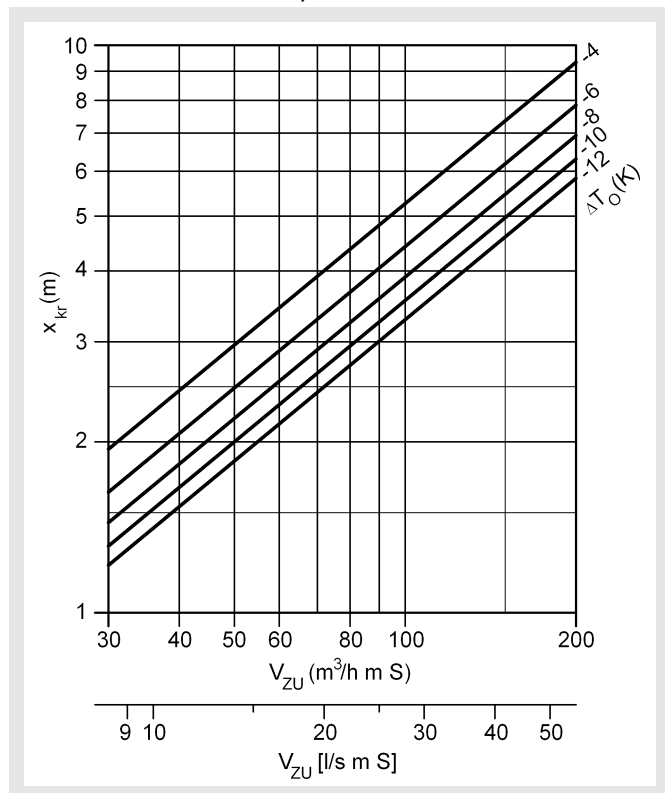

#### Correction factors for x-critical DSX-XXL-W

Slot lengths	c factor	
	DSX-XXL-W-1	DSX-XXL-W-2
1200mm	x0,80	x1,20
1000mm	x1,00	x1,50
900mm	x1,14	x1,71
800mm	x1,28	x1,92
700mm	x1,44	x2,16
600mm	x1,61	x2,42
500mm	x1,69	x2,54
400mm	x1,81	x2,72

# Air Diffuser System Model AUDIX®-AW

## AUDIX®-AW-DSC-401/402

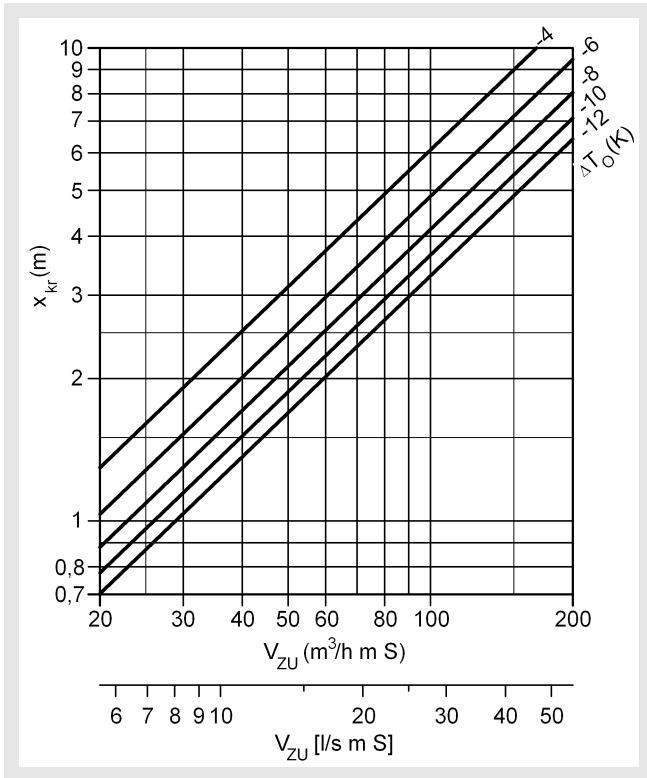

### Correction factors for x-critical DSC

Slot lengths	c factor	
	DSC-401	DSC-402
1200mm	x0,80	x0,96
1000mm	x1,00	x1,20
900mm	x1,26	x1,51
800mm	x1,34	x1,60
700mm	x1,38	x1,65
600mm	x1,50	x1,80
500mm	x1,63	x1,95
400mm	x1,77	x2,12

## AUDIX®-AW-DSA-D-1

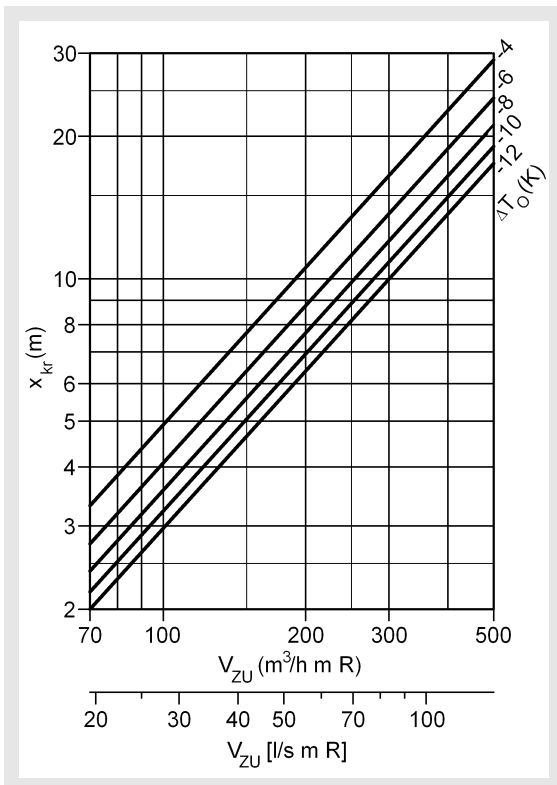

### Correction factors for x-critical DSA-D

Slot lengths	c factor DSA-D-1
1200mm	x0,80
1000mm	x1,00
900mm	x1,24
800mm	x1,39
700mm	x1,59
600mm	x1,89
500mm	x2,24
400mm	2,80

## Air Diffuser System Model AUDIX®-AW

### AUDIX®-AW-DSA-VD-1

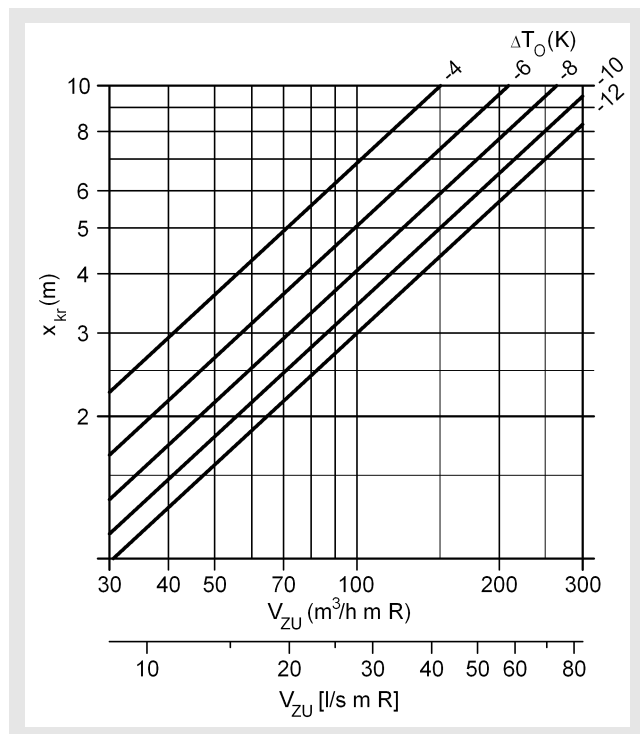

### Correction factors for x-critical DSA-VD

Slot lengths	c factor	
	DSA-VD positioned upwards	DSA-VD positioned straight
1200mm	x0,90	x0,99
1000mm	x1,00	x1,10
900mm	x1,06	x1,16
800mm	x1,11	x1,22
700mm	x1,25	x1,37
600mm	x1,38	x1,52
500mm	x1,51	x1,66
400mm	x1,64	x1,80

## Temperature and induction ratios

### Audix®-AW-DSX-1/2/3/4

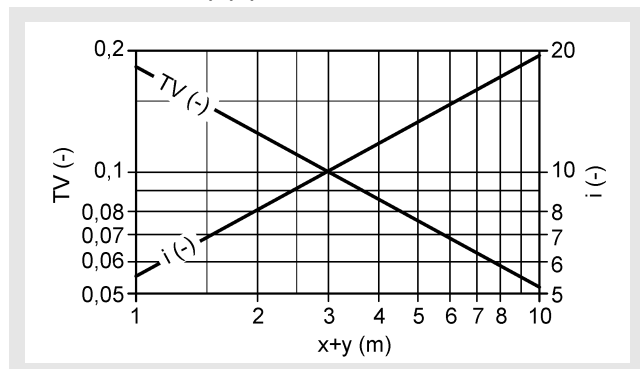

### Correction factors for temperature ratio DSX

Slot lengths	c factor (TV)			
	DSX-1	DSX-2	DSX-3	DSX-4
1200mm	x1,25	x1,58	x1,76	x2,38
1000mm	x1,00	x1,26	x1,41	x1,91
900mm	x0,98	x1,23	x1,38	x1,87
800mm	x0,97	x1,22	x1,36	1,85
700mm	x0,89	x1,12	x1,25	x1,70
600mm	x0,84	x1,06	x1,18	x1,60
500mm	x0,78	x0,98	x1,09	x1,49
400mm	x0,73	x0,92	x1,03	x1,39

### Correction factors for induction ratio DSX

Slot lengths	c factor (i)			
	DSX-1	DSX-2	DSX-3	DSX-4
1200mm	x0,80	x0,63	x0,57	x0,42
1000mm	x1,00	x0,79	x0,71	x0,52
900mm	x1,02	x0,81	x0,72	x0,53
800mm	x1,03	x0,82	x0,74	x0,54
700mm	x1,12	x0,89	x0,80	x0,58
600mm	x1,18	x0,94	x0,84	x0,62
500mm	x1,28	x1,02	x0,92	x0,67
400mm	x1,37	x1,08	x0,97	x0,72

# Air Diffuser System Model AUDIX®-AW

## AUDIX®-AW-DSC-401/402

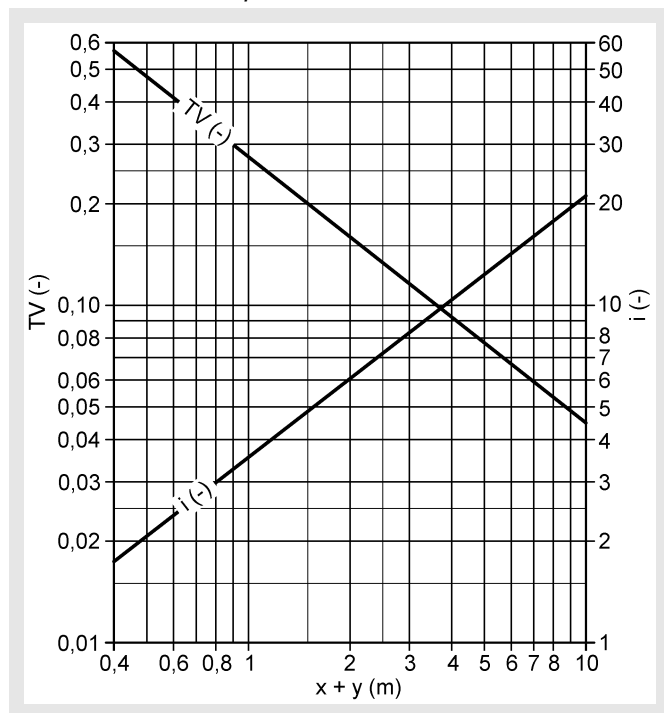

## Correction factors for temperature ratio DSX-XXL-W

Slot lengths	c factor (TV)	
	DSX-XXL-W-1	DSX-XXL-W-2
1200mm	x1,25	x1,73
1000mm	x1,00	x1,38
900mm	x0,95	x1,31
800mm	x0,89	x1,23
700mm	x0,83	x1,15
600mm	x0,77	x1,06
500mm	x0,70	x0,97
400mm	x0,63	x0,87

## Correction factors for induction ratio DSX-XXL-W

Slot lengths	c factor (i)	
	DSX-XXL-W-1	DSX-XXL-W-2
1200mm	x0,80	x0,58
1000mm	x1,00	x0,71
900mm	x1,06	x0,71
800mm	x1,12	x0,80
700mm	x1,21	x0,86
600mm	x1,31	x0,93
500mm	x1,44	x1,02
400mm	x1,62	x1,15

## AUDIX®-AW-DSC-401/402

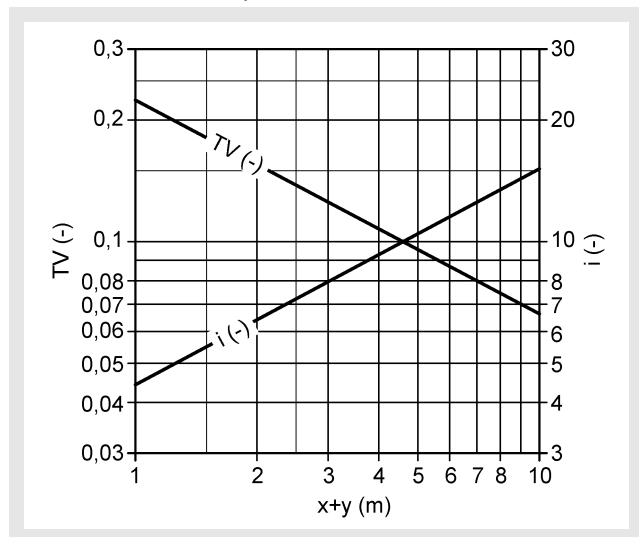

## Correction factors for temperature and induction ratio DSC

Slot lengths	c factor (TV)		c factor (i)	
	DSC-401	DSC-402	DSC-401	DSC-402
1200mm	x1,25	x1,65	x0,80	x0,61
1000mm	x1,00	x1,32	x1,00	x0,75
900mm	x0,98	x1,29	x1,02	x0,77
800mm	x0,97	x1,28	x1,03	x0,78
700mm	x0,89	x1,17	x1,12	x0,85
600mm	x0,84	x1,10	x1,18	x0,90
500mm	x0,78	x1,03	x1,28	x0,97
400mm	x0,73	x0,96	x1,37	1,04

## Air Diffuser System Model AUDIX®-AW

### AUDIX®-AW-DSA-D-1

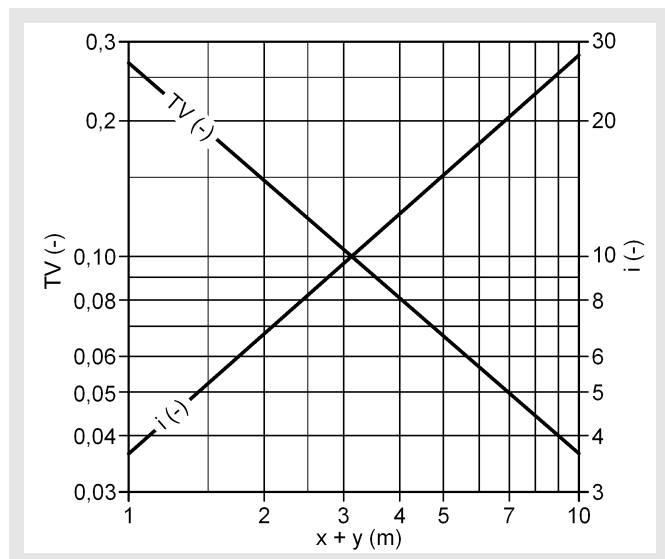

### Correction factors for temperature and induction ratio DSA-D

Slot lengths	c factor (TV)	
	DSA-D-1	DSA-D-1
1200mm	x1,25	x0,80
1000mm	x1,00	x1,00
900mm	x0,95	x1,05
800mm	x0,91	x1,10
700mm	x0,84	x1,19
600mm	x0,79	x1,27
500mm	x0,71	x1,40
400mm	x0,64	x1,57

### Correction factors for temperature ratio DSA-VD

Slot lengths	c factor (TV)	
	DSA-VD positioned upwards	DSA-VD positioned straight
1200mm	x1,13	x0,73
1000mm	x1,00	x0,65
900mm	x0,94	0,62
800mm	x0,88	x0,58
700mm	x0,87	x0,57
600mm	x0,85	x0,55
500mm	x0,76	x0,49
400mm	x0,64	x0,41

### Correction factors for induction ratio DSA-VD

Slot lengths	c factor (i)	
	DSA-VD positioned upwards	DSA-VD positioned straight
1200mm	x0,88	x1,36
1000mm	x1,00	x1,53
900mm	x1,06	x1,61
800mm	x1,13	x1,72
700mm	x1,15	x1,75
600mm	x1,17	x1,81
500mm	x1,31	x2,04
400mm	x1,56	x2,43

### Legend

- $V_{ZU}$  (m<sup>3</sup>/h) = Supply air volume
- $V_{ZU}$  [l/s] = Supply air volume
- $V_{ZU}$  (m<sup>3</sup>/h m S) = Supply air volume per metre of slot
- $V_{ZU}$  [l/s m S] = Supply air volume per metre of slot
- $V_{ZU}$  (m<sup>3</sup>/h m R) = Supply air volume per metre of row
- $V_{ZU}$  [l/s m R] = Supply air volume per metre of row
- $V_X$  (m<sup>3</sup>/h) = total air jet volume at point x
- $V_X$  [l/s] = total air jet volume at point x
- $x+y$  (m) = horizontal and vertical throw
- $\Delta T_0$  (K) = Temperature difference between supply air temperature and room temperature ( $\Delta T_0 = t_{ZU} - t_R$ )
- $\Delta T_X$  (K) = Temperature difference at point x
- $t_{ZU}$  (°C) = Supply air temperature
- $t_R$  (°C) = Room temperature
- $V_{max}$  (m/s) = Maximum end velocity of jet
- $i$  (-) = Induction ratio ( $i = V_X / V_{ZU}$ )
- TV (-) = temperature ratio ( $TV = \Delta T_X / \Delta T_0$ )
- $x_{kr}$  (m) = Critical throw

# Air Diffuser System Model AUDIX®-AW

## Ordering details

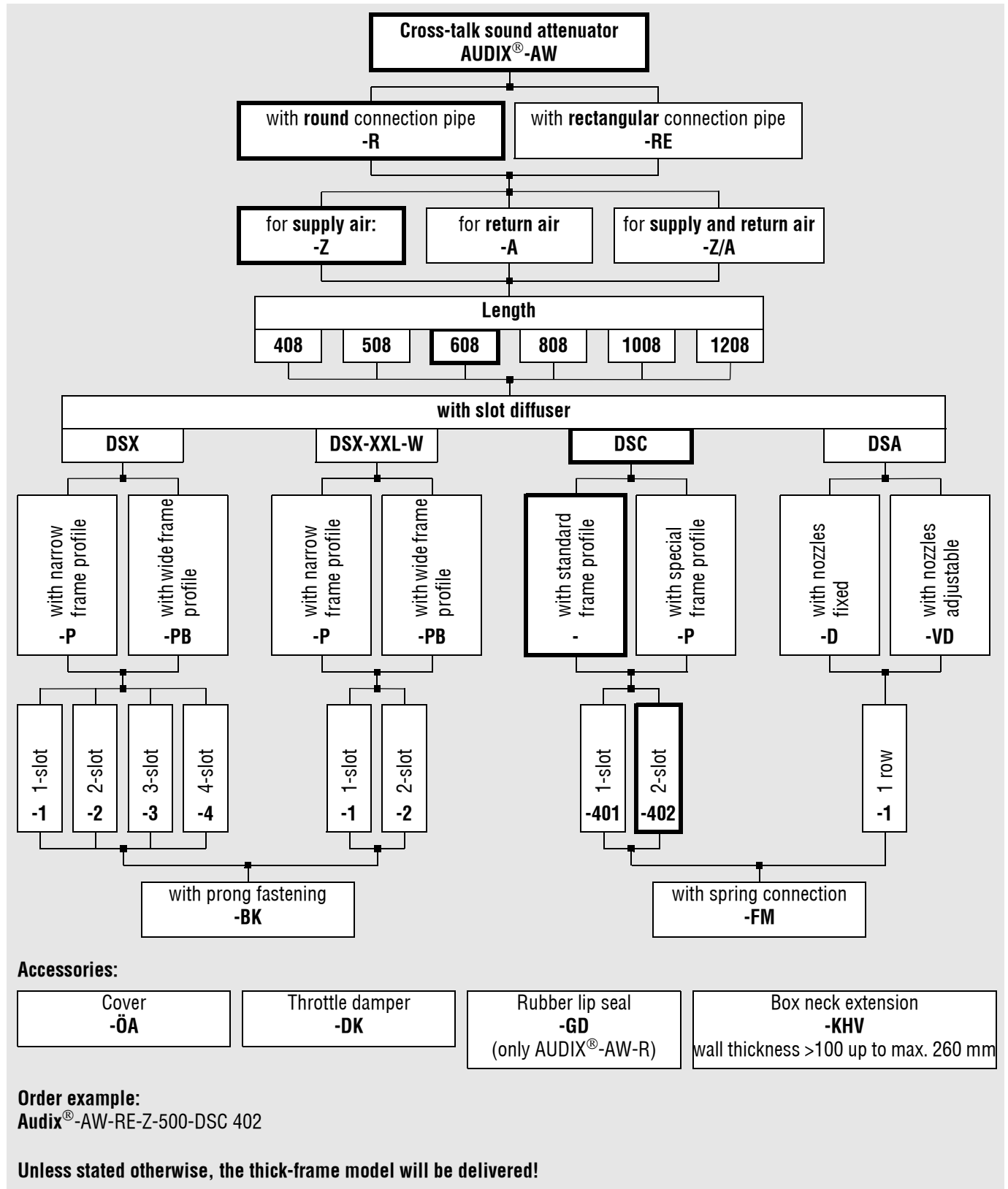

## Air Diffuser System Model AUDIX®-AW

### Specification texts

Air diffuser system for supply air, with rectangular connection pipe, with integrated silencer for installation in front of lightweight walls for connection of 1 diffuser. Plenum box made of galvanised sheet steel. Integrated silencer to prevent cross-talk and for silencing in the duct consisting of an abrasion-resistant absorption material attached on both sides laid out as a reverse labyrinth, including a fitting system to install it outside the posts of lightweight walls.

Product: SCHAKO Type **AUDIX®-AW-RE-Z**

- Air diffuser system for return air

Product: SCHAKO Type **AUDIX®-AW-RE-A**

- Air diffuser system for supply and return air

Product: SCHAKO Type **AUDIX®-AW-RE-Z/A**

- Air diffuser system for return air, with rectangular connection pipe, with integrated silencer for installation in front of lightweight walls to connect 1 diffuser.

Product: SCHAKO Type **AUDIX®-AW-R-Z**

- Air pass system for return air, with round spigot, with integrated silencer for installation in front of lightweight walls for connection of 1 diffuser.

Product: SCHAKO Type **AUDIX®-AW-R-A**

- Air diffuser system for supply and return air, with round connection pipe, with integrated silencer for installation in front of lightweight walls to connect 1 diffuser.

Product: SCHAKO Type **AUDIX®-AW-R-Z/A**

Equipped with:

Diffuser type: ..... from SCHAKO for subsequent final assembly, with concealed fixing via springs.

Simple assembly and disassembly for maintenance purposes, attractive design on room side .

Diffusers:

- DSA-1: 1 row

- Sheet steel faceplate painted to RAL 9005 (black) or RAL 9010 (white)

- Plastic nozzles RAL 9005 (black, standard)) or RAL 9010 (white)

- Fixed (-D) or adjustable (-VD) nozzles

- with spring connection (-FM)

Product: SCHAKO Type **DSA-1**

- DSC40..: 1 or 2 slots

- Frame profile made of aluminium natural colour anodised (E6/EV1) or aluminium painted to RAL 9010 (white)

- Pivoting air deflection blades in support blade profile form made of plastic (hard PVC)

- RAL 9005 (black),

- RAL 9010 (white) or

- Aluminium painted to the same RAL colour as the frame. Subsequent adjustment of blades not possible.

- End pieces on both sides

- With standard frame profile (-) or with special frame profile (-P)

- with spring connection (-FM)

Product: SCHAKO type **DSC 401 or 402**

- DSX: 1, 2, 3 or 4 slots

- Frame profile made of aluminium natural colour anodised (E6/EV1) or aluminium painted to RAL 9010 (white)

- Blades made of plastic RAL 9005 (black) or RAL 9010 (white)

- End pieces on both sides

- with narrow frame profile (-P) or wide frame profile (-PB)

- with prong fastening (-BK)

Product: SCHAKO type **DSX-...**

- DSX-XXL-W: 1 or 2 slots

- Frame profile made of aluminium natural colour anodised (E6/EV1) or aluminium painted to RAL 9010 (white)

- Blades made of plastic RAL 9005 (black) or RAL 9010 (white)

- End pieces on both sides

- with narrow frame profile (-P) or wide frame profile (-PB)

- with prong fastening (-BK)

Product: SCHAKO type **DSX-XXL-W-...**

#### Accessories:

- Cover (ÖA) to prevent soiling or damage during assembly, made of galvanised sheet steel with fixing via springs.

- Throttle damper (-DK), manually adjustable from room side. Throttle made of galvanised sheet steel

- Rubber lip seal (-GD), made of special rubber (only AU-DIX®-AW-R-...)

- Box neck extension (-KHV) for wall thicknesses >100 mm